

CP-4

4 HEAD FILLER | SEAMER

Quality in All Conditions



20-30

Cans Per Minute

55" x 27"

Operating Footprint

Single

Operator

Integrated

Tank Control

Versatile: Counterpressure technology is able to fill cans with any type of beverage, from still products up to the most carbonated beverages in your line.

Hassle-free: An intuitive, user-friendly interface removes the complications from the counterpressure machine experience.

Fully automated: Filling 20-30 cans per minute of any beverage type and nearly any can size is possible with this system that delivers consistent, high-quality fills.

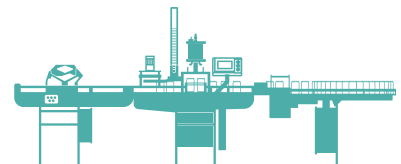

Build a complete line with ACM.

RT-212 Infeed Table

Offering expanded accumulation, pre-rinse, and an integrated mount for date coders.

PTA Can Handle Applicator

Reduce the number of operators needed by automatically applying PakTech® brand handles.

CP-4

Counterpressure
4 Head Filler | Seamer

Machine Specifications

| | |
|------------------------------------|--|
| Machine Weight | 258.9 LBS |
| Power Requirements | 1.7A @ 110-120 VAC, 50 Hz |
| | 1.7A @ 110-120 VAC, 60 Hz |
| | 0.85A @ 220-240 VAC, 50 Hz |
| | 0.85A @ 220-240 VAC, 60 Hz |
| Compressed Air Requirements | Pressure: 100 to 170 PSI Flow Rate: 10 SCFM (FAD) @100 PSI (1.3 ACFM @ 100 PSI) |
| CO₂ Requirements | Pressure: 60-90 PSI Regulator Flow Coefficient: 0.15 Cv or Higher |

| Connections | |
|--|---------------------------|
| Air In | 1/4" Industrial QC Male |
| CO₂ In | 1/4" Industrial QC Male |
| Product In | 1.5" Sanitary Tri-Clamp |
| Rinse Water In | 3/4" GHT Female |
| Drain Pan Out | 3/4" GHT Male |
| Tank Control CO₂ Out | 1/4" Industrial QC Female |

| Supply Compatibility | |
|-----------------------------|--------------------|
| Can Diameter | Standard 211 |
| | Sleek 204 |
| | Slim 202 |
| End Style & Size | CDLW (200) |
| | CDL-E (202) |
| | CDL+ (202) |
| | SuperEnd® (202) |
| | B64/LOE (200, 202) |

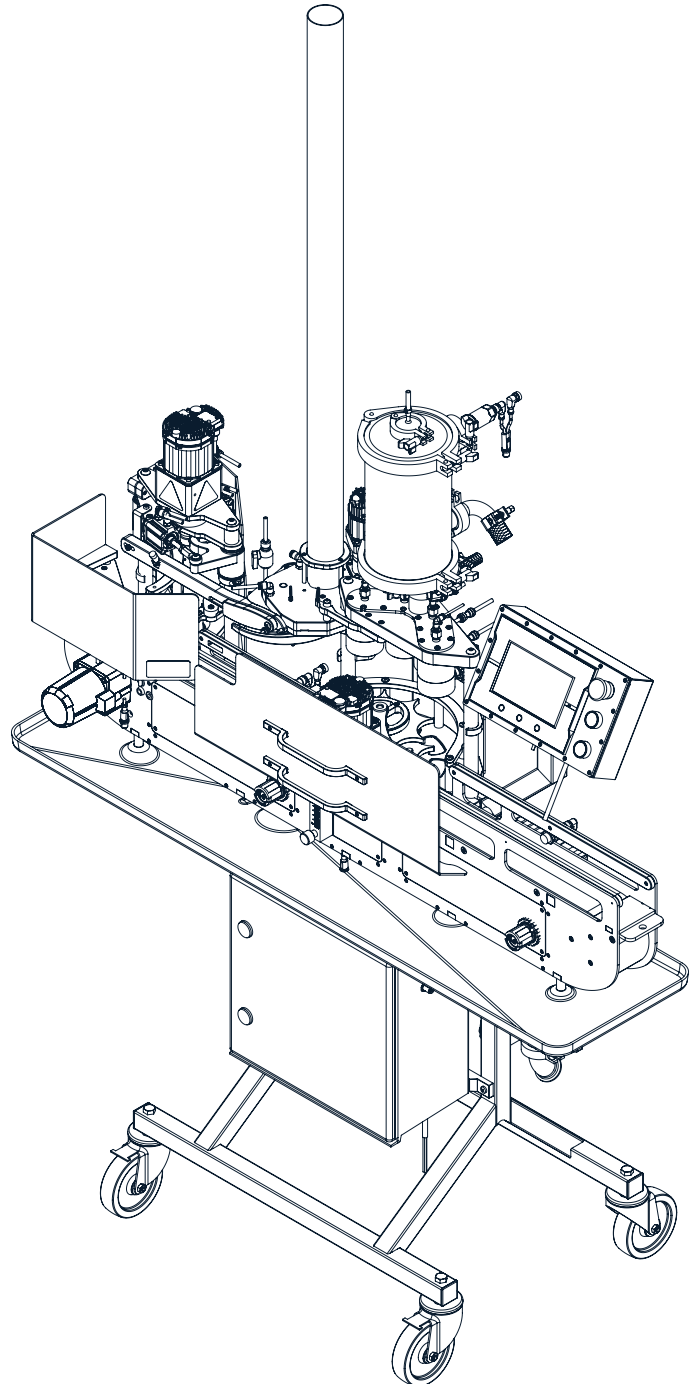

CP-4

Counterpressure
4 Head Filler | Seamer

Machine Specifications

TOP VIEW

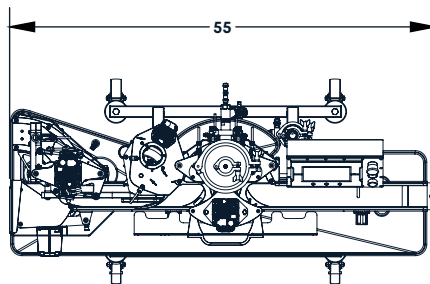

FRONT VIEW

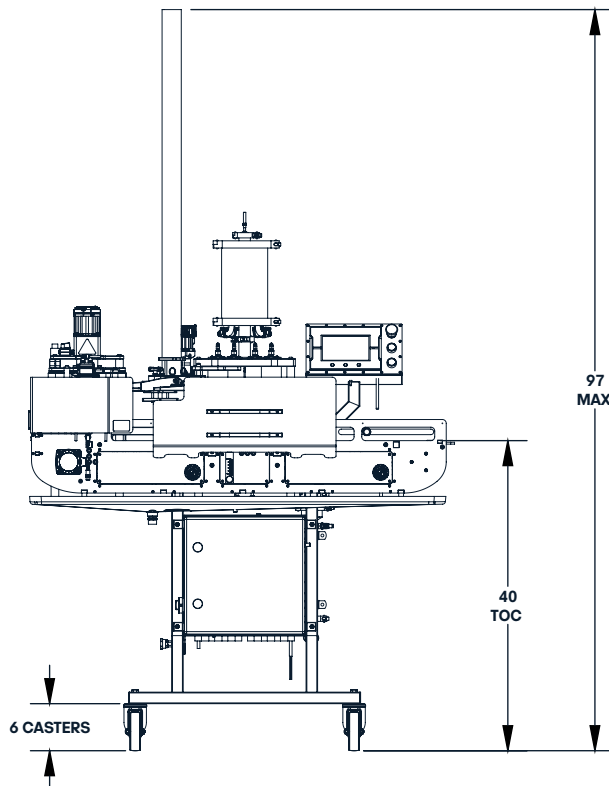

SIDE VIEW

